

TOOLS REQUIRED

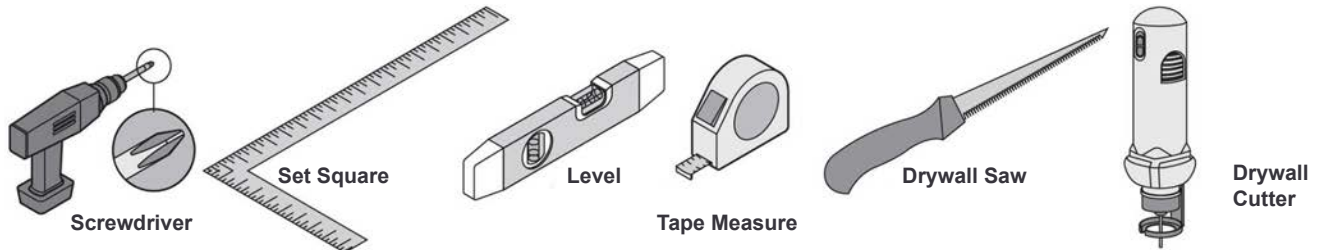

FRAMING GUIDE

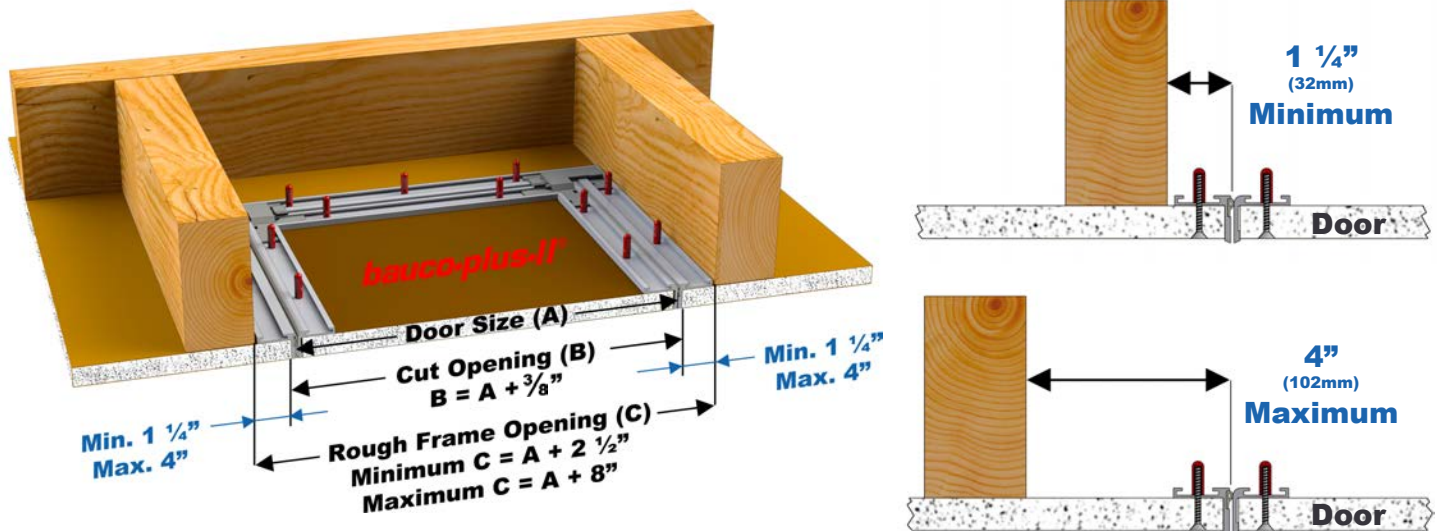

Key Concept: The panel attaches to the surrounding drywall

- 1 Doors size (A) is the last 4 digits of the model # 20-58-1212 (example: door size 12" x 12")
This is the clear opening of the panel when the door leaf is removed.
- 2 Cut Opening (B) is the Door Size (A) + 3/8" (example: cut opening 12 3/8")
This is the size of the opening you will cut into the drywall.
- 3 Rough Frame Opening (C) is the measurement from inside stud to inside stud of the surrounding framework. Minimum Rough Frame Opening (C) is Door Size (A) + 2 1/2"
(example: min framing 14 1/2")

OPENING IN GYPSUM WALL BOARD

- 4 Determine the location for the Access Panel and mark the outline for your cut opening (B).
Accurate marking is very important and make sure that the lines are square. Cut the opening with a saw or drywall cutter. Make sure the edges are clean.



Important: When the Access Panel is being fitted into a wall, position the unit with the latches at the top.

POSITION FRAME & ATTACH TO DRYWALL

- 5 Remove the door leaf from the frame. Pass the Access Panel through the opening and pull the frame back into position. Frame must be attached with corners **square** and all lengths **straight**. This ensures the door will operate properly. (see video for alternate methods)

- 6 Screw through the face of the drywall into the frame of the Access Panel. Stay at least 2" (51mm) away from the corners to avoid hitting the steel corner in the frame. **The maximum distance between screws is 4" (102mm)**

Self drilling drywall screw
recommended



1 1/4" (32mm) Safety Cap

Key Concept: Use correct amount of screws

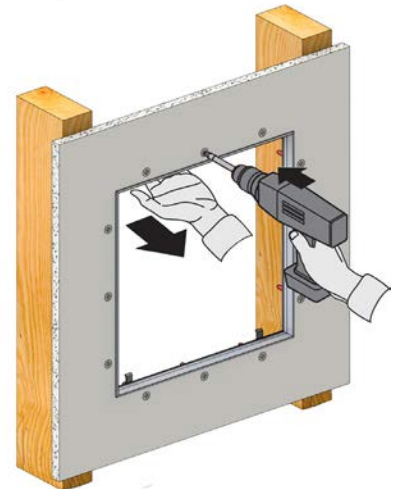
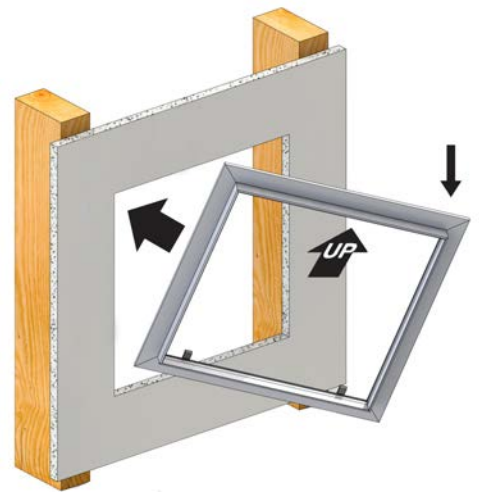
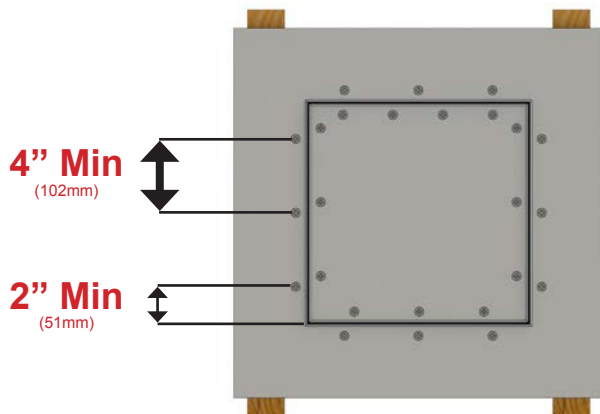

- 7 Test the door opens correctly.

FINISHING: MUDDING & SANDING

- 8 We **recommend** using **setting-type** gypsum finishing compound. Press the compound into any gaps around frame. Apply compound to the inner door leaf **separately**, filling to the height of the raised outer edge. Sand and refill to desired finish. **Clean** the frame and door leaf with a damp cloth. Connect safety cable.

